

linear dimension(Tolerances Standard GB/T 14486-2008)								—	$\nabla$	$\perp$
variable range	to 6	over 6	over 10	over 30	over 60	over 100	over 160	to 10	over 10	over 100
		to 10	to 30	to 60	to 100	to 160	to 100		to	
tolerance	±0.20	±0.30	±0.50	±0.70	±1.00	±1.30	±1.60	0.10	0.30	0.60

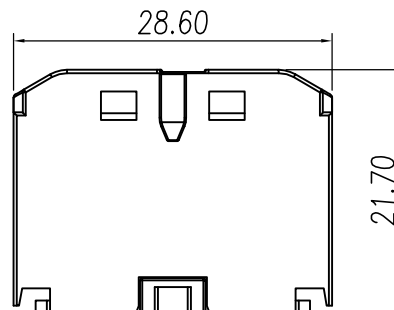
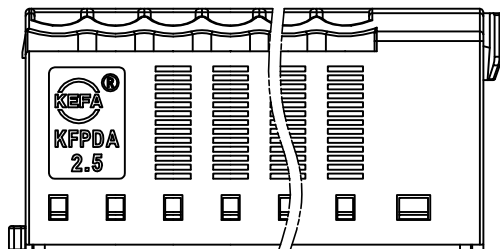
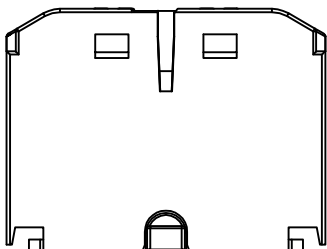
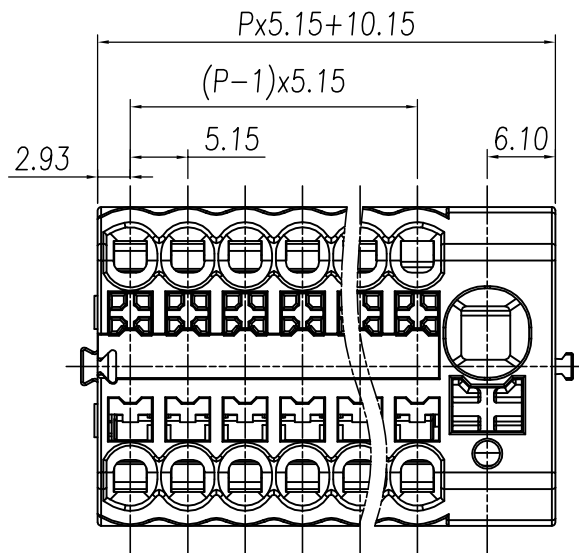

REVISION RECORD				
REV.	DESCRIPTION	ECN No.	APPROVED	DATE
A	新发行		CLF	22.04.11

UL/CUL 技术参数 UL/CUL Technical Data							
等级	Use Group	B	C	D			
额定电压	Rated Voltage [V]	300	300	600			
额定电流	Rated Current [A]	50/20	50/20	5			
接线范围	Wire Range	输入端: 20-8			输出端: 26-12		
单/多芯线	Solid/Stranded [AWG]						
耐电压	Withstanding Voltage	1600V/1Min					
IEC 技术参数 IEC Technical Data							
过电压类别	Overvoltage Category	III	-	-			
污染等级	Contamination Class	3	-	-			
额定电压	Rated Voltage [V]	690	-	-			
额定电流	Rated Current [A]	输入端: 41			输出端: 24		
额定冲击电压	Impulse withstand voltagea [KV]	8.0	-	-			
导线截面积	Conductor cross section	输入端: 0.5-6(10sol)			输出端: 0.2-2.5(4sol)		
硬质/柔性导线	Solid/flexible [mm <sup>2</sup> ]						
材料 Material							
绝缘材料	Insulation Material	PA66					
阻燃等级	Imflamability	UL94V-0					
导体材料	Contactior Material	铜合金 Copper alloy					
导体表面镀层	Contactive Coating	镀锡 Tin Plated					
一般参数 Other Data							
间距	Pitch [mm]	5.15					
极数	Poles [P]	02P~16P					
剥线长度	Stripping Length [mm]	输入端: 10-12			输出端: 8-10		
螺丝	Screw/扭矩 Torque(Max) [N.m]	-					
工作温度	Operating temperatur [°C]	-40~+105					
引针尺寸	Pin Dimensions [mm]	-					
PCB板孔径	PCB Hole Diameter [mm]	-					

DES.	WW	DATE	22.04.11
CHK.	BY	DATE	22.04.11
APP.	CLF	DATE	22.04.11

单位/UNITS	mm	尺寸/SIZE	A4	比例/SCALE	1:1	第三视角/THIRD ANGLE PROJECTION	版本/REV	A
							名称/TITLE	KFPDA2.5
慈溪市科发电子有限公司 CIXI KEFA ELECTRONIC CO., LTD								